

Approved as noted

M G Vancil 6/26/18
Transportation
Operations

Wait until Lower
Spokane Bridge
reopened, as well as
non-event weekends

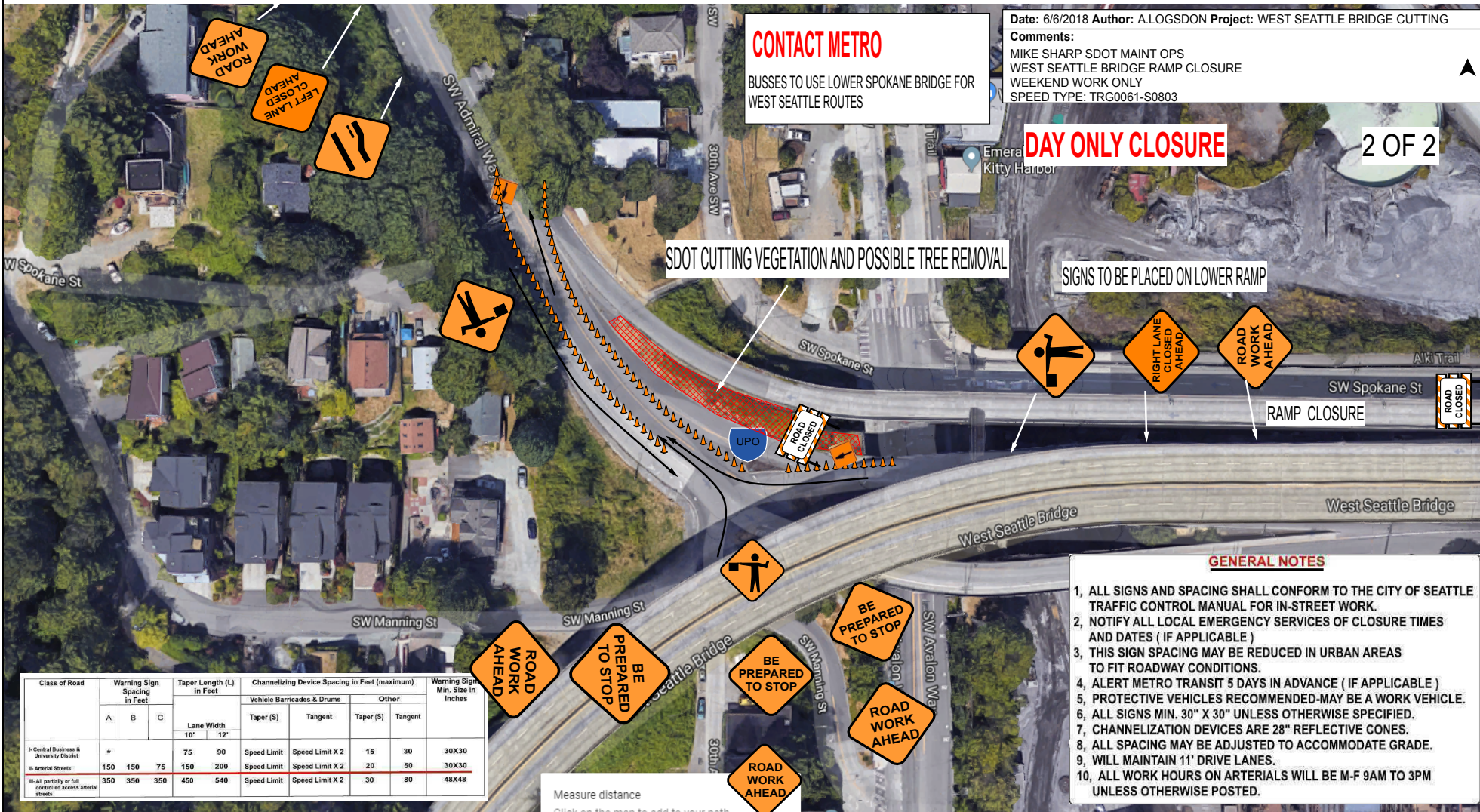

Date: 6/6/2018 Author: A.LOGSDON Project: WEST SEATTLE BRIDGE CUTTING
Comments:
MIKE SHARP SDOT MAINT OPS
WEST SEATTLE BRIDGE RAMP CLOSURE
WEEKEND WORK ONLY
SPEED TYPE: TRG0061-S0803

CONTACT METRO
BUSES TO USE LOWER SPOKANE BRIDGE FOR WEST SEATTLE ROUTES

DAY ONLY CLOSURE

2 OF 2

SDOT CUTTING VEGETATION AND POSSIBLE TREE REMOVAL

SIGNS TO BE PLACED ON LOWER RAMP

RAMP CLOSURE

GENERAL NOTES

- 1, ALL SIGNS AND SPACING SHALL CONFORM TO THE CITY OF SEATTLE TRAFFIC CONTROL MANUAL FOR IN-STREET WORK.
- 2, NOTIFY ALL LOCAL EMERGENCY SERVICES OF CLOSURE TIMES AND DATES (IF APPLICABLE)
- 3, THIS SIGN SPACING MAY BE REDUCED IN URBAN AREAS TO FIT ROADWAY CONDITIONS.
- 4, ALERT METRO TRANSIT 5 DAYS IN ADVANCE (IF APPLICABLE)
- 5, PROTECTIVE VEHICLES RECOMMENDED-MAY BE A WORK VEHICLE.
- 6, ALL SIGNS MIN. 30" X 30" UNLESS OTHERWISE SPECIFIED.
- 7, CHANNELIZATION DEVICES ARE 28" REFLECTIVE CONES.
- 8, ALL SPACING MAY BE ADJUSTED TO ACCOMMODATE GRADE.
- 9, WILL MAINTAIN 11' DRIVE LANES.
- 10, ALL WORK HOURS ON ARTERIALS WILL BE M-F 9AM TO 3PM UNLESS OTHERWISE POSTED.

Class of Road	Warning Sign Spacing in Feet			Taper Length (L) in Feet		Channelizing Device Spacing in Feet (maximum)				Warning Sign Min. Size in Inches
	A	B	C	Lane Width		Vehicle Barricades & Drums		Other		
				10'	12'	Taper (S)	Tangent	Taper (S)	Tangent	
I- Control Business & University District	*			75	90	Speed Limit	Speed Limit X 2	15	30	30X30
II- Arterial Streets	150	150	75	150	200	Speed Limit	Speed Limit X 2	20	50	30X30
III- All partially or full controlled access arterial streets	350	350	350	450	540	Speed Limit	Speed Limit X 2	30	80	48X48

Measure distance
Click on the map to add to your path