

California Ave SW

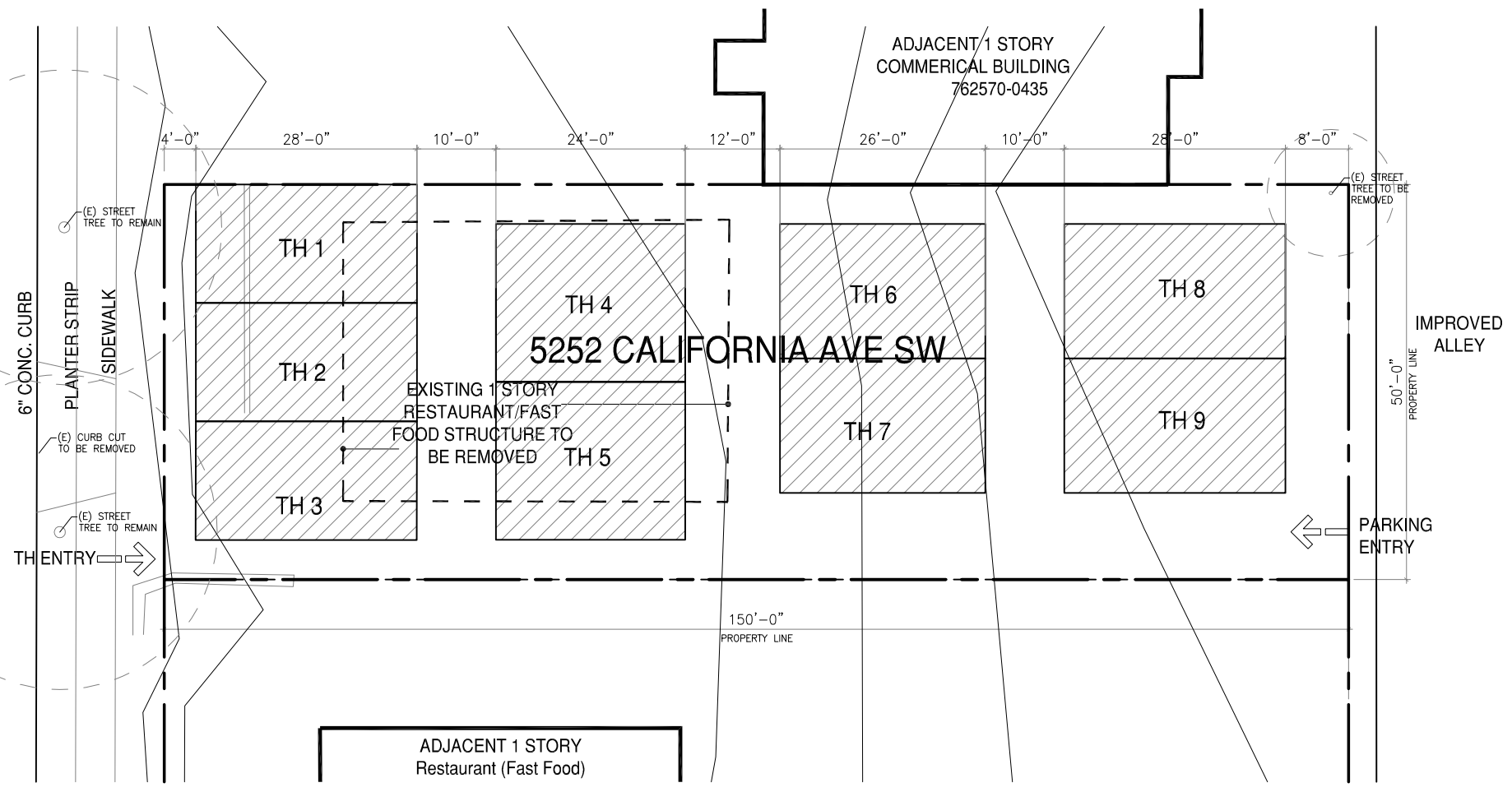

site plan

scale: 1" = 20'

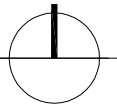

OWNER: LEXINGTON ASSET MANAGEMENT  
 DPD PROJECT NO:  
 ADDRESS: 5252 CALIFORNIA AVE SW | Seattle, WA 98136  
 ASSESSOR PARCEL NO. #7625700430  
 SITE AREA: 7,500 SF  
 ZONING: NC2-30  
 OVERLAY: Frequent Transit  
 ECA: None  
 LEGAL DESCRIPTION: SEA VIEW PARK ADD  
 Plat Block: 4  
 Plat Lot: 14  
 GROSS SF: 14,000 SF

PROJECT DESCRIPTION:  
 Development of (9) townhouse units on an existing lot. Includes (8) new underground parking spaces and the demolition of an existing 1-story commercial structure.

**HYBRID Architecture**

1205 EAST PIKE ST - SUITE 2D  
 SEATTLE, WA 98122  
 206-267-9277  
 www.hybridarc.com

5252 CALIFORNIA AVE SW | Seattle, WA 98136